

ASSEMBLING INSTRUCTIONS
ITEM: 373250D, 373261D, 373272D
' DIMMABLE ITEM

ATTENTION: Schuller recommends to use included special screws when installing this lamp.

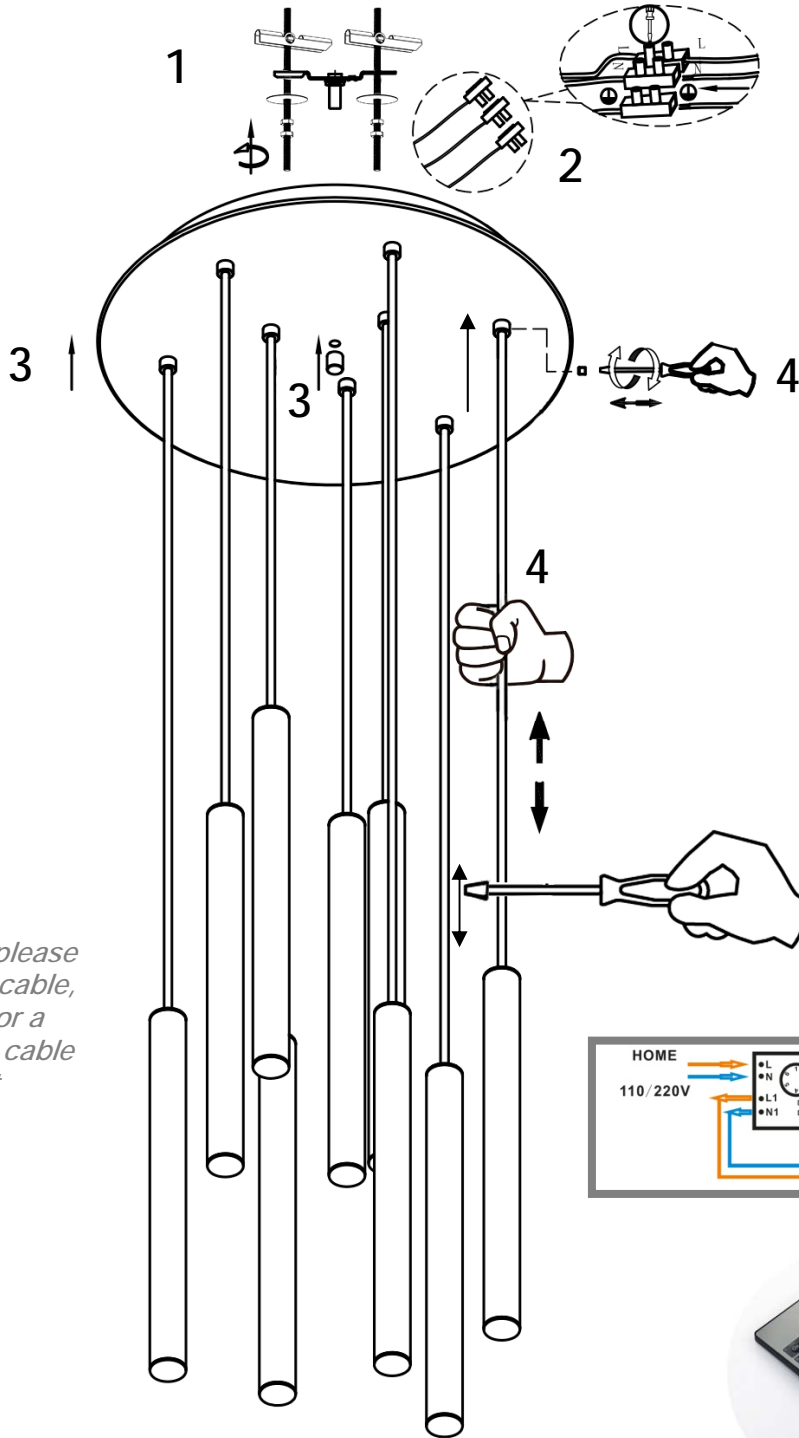

IMPORTANT NOTICE:
 If the cable is twisted, please hold the bottom of the cable, and use a screwdriver or a metal rod to stroke the cable up and down to keep it straight.

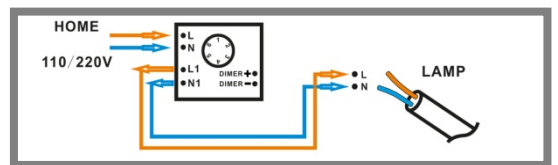

WARNING

This product includes LEDs with 0-10V or PWM dimming. To use it with wall dimmer, use just this type of dimmers. Any other type would damage the LED driver. The receiver installed in the product has channel 1 selected. Use this channel also on the remote control.