

**TALEXdriver LCBI 15W 350/500/700mA BASIC phase-cut SR**

BASIC series

Constant current LED Drivers from the BASIC series are suitable for the professional modernization of inefficient low voltage halogen installations as well as for decorative lighting and accent lighting of offices, sales spaces, hotels, restaurants, art galleries and museums. Tridonic provides a coordinated system with own SLE and CLE modules, but the LED Drivers can also be used with other LED modules. All LED Drivers are SELV-compliant, available as recessed or independent variants and provide economic dimming convenience via amplitude dimming from 10 to 100%.

**Product description**

- \_ Dimmable via leading edge and trailing edge phase dimmers
- \_ Nominal life-time up to 50,000 h (at ta 50 °C with a failure rate  $\leq 0.2$  % per 1,000 h)
- \_ 350, 500 or 700 mA output current
- \_ Push-in terminals
- \_ Connecting cable, wire cross-section 0.5 – 2.5 mm<sup>2</sup>
- \_ Output power 14/15 W
- \_ SELV
- \_ Type of protection IP20
- \_ Output dimmed analogue (current amplitude)
- \_ Dimming range typ. 5 to 100 % (depending on dimmer)

**Properties**

- \_ Casing: polycarbonate, white
- \_ Compact dimensions
- \_ Overload protection
- \_ Short-circuit protection
- \_ No-load protection

**Website**

<http://www.tridonic.com/89800266>



Spotlights



Downlights



Linear



Area



Floor | Wall



Free-standing



Street



Decorative



High bay

**TALEXdriver LCBI 15W 350/500/700mA BASIC phase-cut SR**

BASIC series

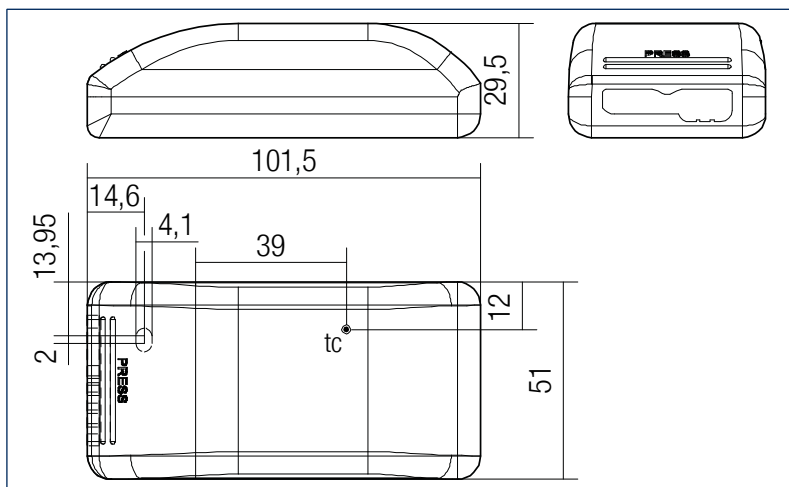

**Ordering data**

| Type                              | Article number | Packaging, carton | Packaging, pallet | Weight per pc. |
|-----------------------------------|----------------|-------------------|-------------------|----------------|
| LCBI 15W 350mA BASIC phase-cut SR | 89800266       | 20 pc(s).         | 1,000 pc(s).      | 0.075 kg       |

**Technical data**

|   |                  |
|---|------------------|
| Rated supply voltage                                | 220 – 240 V      |
| Input voltage AC                                    | 198 – 264 V      |
| Mains frequency                                     | 50 / 60 Hz       |
| Typ. rated current (at 230 V, 50 Hz, full load)     | 0.09 A           |
| Power factor at full load <sup>①</sup>              | 0.99             |
| Power factor at min. load <sup>①</sup>              | 0.97             |
| Output current tolerance                            | ± 7.5 %          |
| Output current tolerance at full load <sup>②③</sup> | ± 7.5 %          |
| Typical ripple current at full load                 | ± 30 %           |
| Turn on time (at 230 V, 50 Hz, full load)           | ≤ 0.1 s          |
| Turn off time (at 230 V, 50 Hz, full load)          | ≤ 0.1 s          |
| Hold on time at power failure (output)              | 0 s              |
| Ambient temperature ta                              | -25 ... +50 °C   |
| Storage temperature ts                              | -40 ... +85 °C   |
| Dimensions L x W x H                                | 102 x 51 x 30 mm |

**Approval marks**

IP20 SELV RoHS

**Standards**

EN 55015, EN 61000-3-2, EN 61000-3-3, EN 61347-1, EN 61347-2-13, EN 61547, EN 62384

**Specific technical data**

| Type                              | Efficiency at full load <sup>①</sup> | Efficiency at min. load <sup>①</sup> | Output current | Max. repetitive output peak current at full load <sup>②</sup> | Max. repetitive output peak current at min. load <sup>②</sup> | Max. non-repetitive output peak current at full load <sup>③</sup> | Max. non-repetitive output peak current at min. load <sup>③</sup> | Max. forward voltage <sup>④</sup> | Min. forward voltage <sup>④</sup> | Max. output voltage <sup>④</sup> | Max. input power | Max. output power |
|-----------------------------------|--------------------------------------|--------------------------------------|----------------|---|---|---|---|-----------------------------------|-----------------------------------|----------------------------------|------------------|-------------------|
| LCBI 15W 350mA BASIC phase-cut SR | 78 %                                 | 76 %                                 | 350 mA         | 540 mA  | 760 mA  | 540 mA  | 760 mA  | 42 V                              | 21.0 V                            | 51 V                             | 19 W             | 15 W              |

① Test result at 230 V, 50 Hz.

② The trend between min. and full load is linear.

③ Output current tolerance at min. load max. 22 %.

④ At failure mode.

The complete data sheet for this product is available in the Downloads section.