

Installation instructions : Halo Arezzo LED Cabinet Light SY7196

**IMPORTANT—Please read prior to installation**

- 1) Please read these instructions carefully before commencing any work
- 2) This product must be installed by a qualified electrician in accordance with the current IEE wiring regulations
- 3) To prevent electrocution switch the power off at the mains supply before installing or maintaining this fitting
- 4) Ensure others cannot restore the electrical supply without your knowledge
- 5) The PSU must be rated 12VDC and be compatible with the pre-wired connector system of this product
- 6) Never exceed the wattage stated

**INSTALLATION DIAGRAMS**

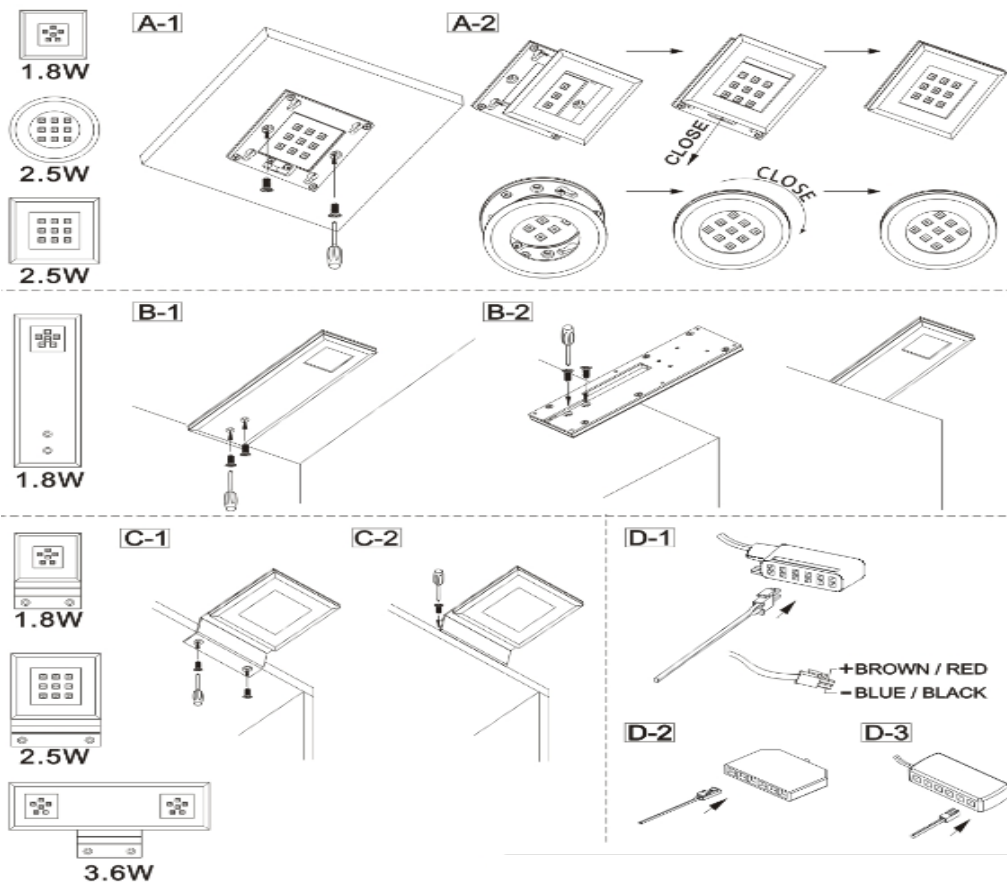

sycamore SY7196



This luminaire contains built-in LED lamps.



} LED

The lamps cannot be changed in the luminaire.

874/2012

